

### Morpla series

Morplast  
Plaster for external and  
internal walls

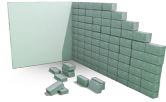

### Morpla series

Morbrick  
Mortar for bricks and  
block laying

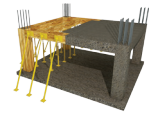

### Ultra series

Ultra Early Strength  
Concrete for faster  
construction (4-72 hours)

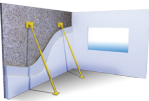

### Ultra series

Ultra Fair Face  
Concrete for smooth surface

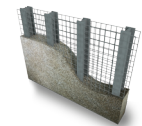

### Ultra series

Ultra Flow  
Concrete for heavy  
reinforcements and  
narrow form works

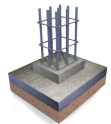

### Ultra series

Water Tight  
Concrete for low permeability  
(underground structures, water tanks, etc.)

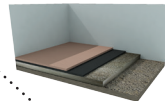

### Ultra series

Ultra Water Proof  
For better performance  
against water penetration

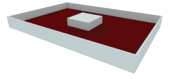

### Ultra series

Ultra Light Weight  
Ultra foam for leveling and slope layer  
Internal and external with thermal  
and lightweight properties

### Hydromedia

Pervious Concrete for  
water management  
and drainage

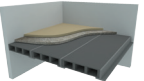
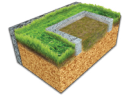

### Ultra series

Ultra Micro Screed  
Fluid "SAP" for  
floor leveling ≥ 4 cm



### Artevia

Artevia Exposed, Artevia  
Printed and Artevia Stone  
For decorative floors

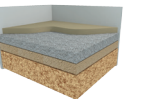

### Ultra series

Ultra Screed  
For floors below 10 cm thick,  
thin walls and columns

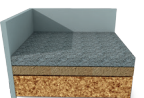

### Ultra series

Ultra Fiber  
PP fibers for floors and side walks  
Steel fibers for industrial floors

### WeatherMix™

For Cold Weather < 5°C  
For Hot Weather > 40°C

